

PLAYER:								CODE:		
SIGNATURE										
HOLE	PAR	W	Y	B	R	O	S.I.	PLAYER(S)		MARKER
1	4	354	342	331	269	223	8			
2	3	177	168	160	152	123	16			
3	5	507	473	413	404	314	6			
4	4	389	374	326	316	241	2			
5	5	481	462	406	398	318	10			
6	3	153	132	130	114	81	18			
7	4	362	336	314	278	223	12			
8	4	322	313	303	264	211	4			
9	4	296	290	282	244	175	14			
OUT	36	3041	2890	2665	2439	1909				
PLAYER(S):								HCP	STROKES	
DATE:								TEE:		

MARKER:								CODE:		
SIGNATURE										
HOLE	PAR	W	Y	B	R	O	S.I.	PLAYER(S)		MARKER
10	4	332	326	317	290	233	3			
11	3	185	177	167	157	124	11			
12	4	361	334	287	278	223	13			
13	4	401	392	342	331	272	1			
14	5	488	480	415	407	319	9			
15	3	161	157	159	137	108	17			
16	4	393	364	317	309	243	5			
17	4	384	359	309	302	242	7			
18	5	451	442	430	393	329	15			
IN	36	3156	3031	2743	2604	2093				
OUT	36	3041	2890	2665	2439	1909				
T	72	6197	5921	5408	5043	4002	T			
RESULT / STFRD				STROKES						
				NETTO						

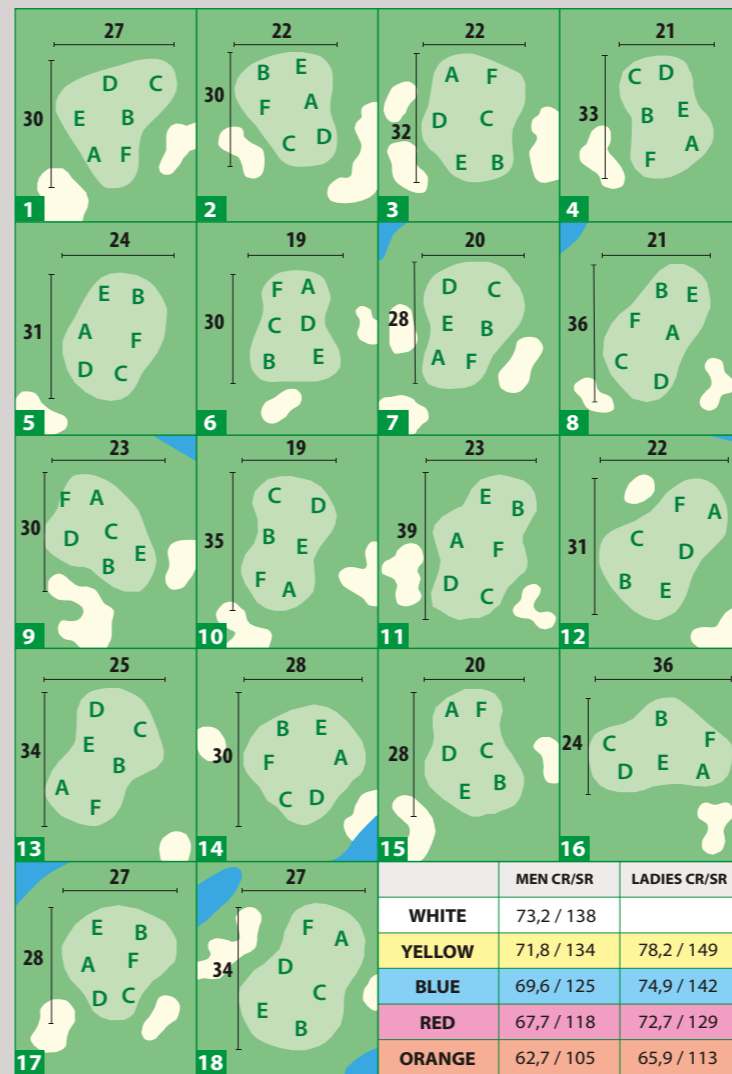

LOCAL RULES

Out of Bounds is marked by white stakes. For players who play the 14th hole, the 16th hole is out of bounds. This boundary is marked by white/red stakes.

Stakes with green tops

Areas marked by stakes with green tops may not be entered and are no play zones.



Ground under repair is marked by blue stakes or white lines. In case of interference of GUR defined by blue stakes the player must take relief under Rule 25-1.

Dropping Zone (hole 9). When a ball is lost in the penalty area behind the green, as an additional option the player may drop a ball in the dropping zone next to the green.

Sprinkler Heads close to the Putting Green. If a ball lies in the General Area and a sprinkler head on or within two club-lengths of the putting green and within two club-lengths of the ball, intervenes on the line of play between the ball and the hole, the player may take relief under Rule 16-1b.

Penalty for breach of a Local Rule: General Penalty (Matchplay: Loss of hole; Strokeplay: two strokes).

Temporary Local Rules: See notice boards in the Clubhouse and at the 1st tee.

Distances are measured to the centre of the green.

PLEASE REPAIR PITCHMARKS, REPLACE DIVOTS AND RAKE BUNKERS



ONBEZORGD OP GOLFOVAKANTIE

- UW ZEKERHEDEN BIJ PIN HIGH**
- ✓ Laagste prijsgarantie
 - ✓ Vele unieke arrangementen
 - ✓ Uw eigen reisadviseur bij elke boeking
 - ✓ 24/7 bereikbaar, ook tijdens uw vakantie
 - ✓ Eigen betrouwbare kwaliteitsinspecteurs
 - ✓ Aangesloten bij   

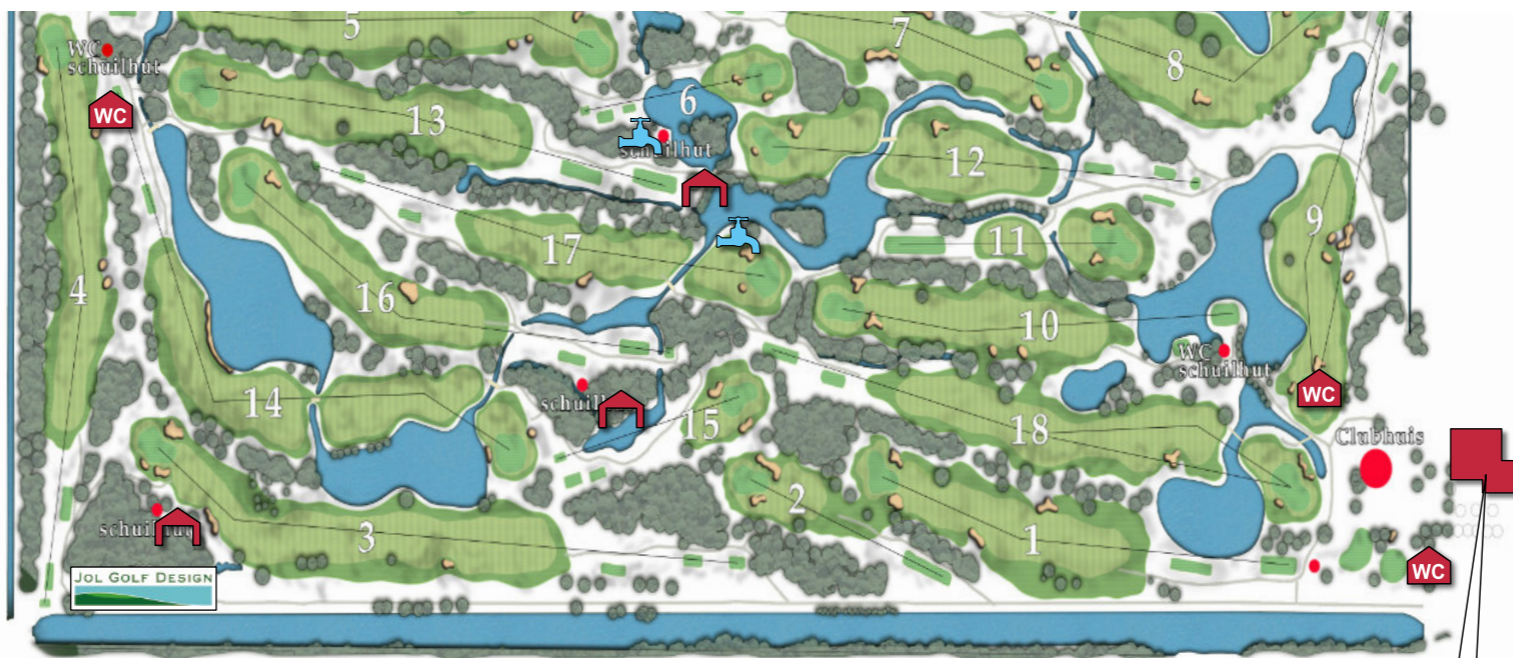





**In case of emergency call the caddiemaster:
06-51291414**

Thunderstorm: interrupt the game and find a shelter.

- **One long horn signal:** interrupt play immediately.
- **Three short horn signals:** interrupt play.
- **Two short horn signals:** resume play.

Het gebruik van de baan is voor eigen risico.
The use of our facilities is at your own risk.

				
shelter+wc+water	shelter	water	clubhouse	AED in the clubhouse

Amsterdamse Golf Club
 Bauduinlaan 35
 1047 HK Amsterdam
 Caddiemaster 06-51291414
 Office 020-4977866
 Restaurant 020-8950822
 Shop 06-49758730
www.amsterdamsegoelfclub.nl



Amsterdamse Golf Club